

TOGLER® SNAPTOGGLE® TOGGLE BOLT ANCHORS • HIGH STRENGTH



Toggles Only			Cardboard Box	
Model	Screw Size	Drill Size	Part #	Box Qty
BA	10-24 (3/16)	1/2	58732 ★	100
BB	1/4-20 (1/4)	1/2	58816 ★	100
BC	3/8-16	3/4	58900 ★	25

★ Made in USA

Mini Kits			Clam Shell	
Screw Size	Drill Size	Part #	Box Qty	
10-24 x 2 Th Sq/Slot	1/2	58742 ★	6	
10-24 x 3 Th Sq/Slot	1/2	58743 ★	6	
10-24 x 4 Th Sq/Slot	1/2	58744 ★	6	
1/4-20 x 3 Th Sq/Slot	1/2	58817 ★	6	
1/4-20 x 4 Th Sq/Slot	1/2	58818 ★	6	

Installation for Models BA & BB

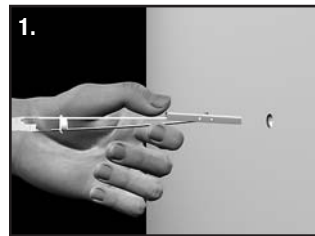

1. Drill 1/2" (Ø13mm) hole. Hold metal channel flat alongside plastic straps and slide channel through hole. Minimum clearance behind wall: 1 7/8" (48mm).

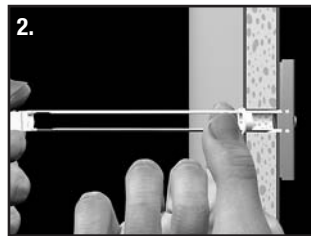

2. Hold ends of straps between thumb and forefinger and pull toward you until channel rests flush behind wall. Slide plastic cap along straps with other hand until flange of cap is flush with wall.

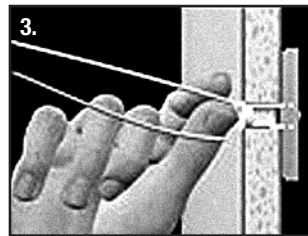

3. Snap straps at wall by pushing side to side, snapping off straps level with flange of cap.

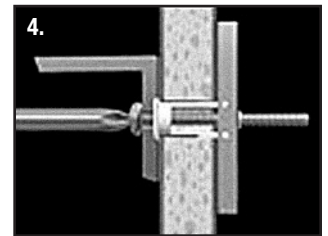

4. Place item over flange. Insert bolt through item and tighten until flush against item, then stop.

Use machine screw or bolt to match thread in channel: BA (3/16"-24), BB (1/4"-20).

Bolt length = item thickness + wall or ceiling thickness + 1/2" (13mm)

U.S. Patent No. 6,161,999 and foreign counterparts thereof and of 4,650,386. Other patents pending. TOGLER and SNAPTOGGLE are worldwide registered trademarks of Mechanical Plastics Corp.

Ultimate Tensile Pull-Out Values (lb)

Anchor	UNC Thread	Drill Dia.	1/2" Drywall	5/8" Drywall	*1/2" and 25 Gauge Stud	*5/8" and 25 Gauge Stud	Concrete Block	1/2" Steel Plate	Stainless in 1/2" Steel ¹
BA	3/16"-24	1/2"	238	356	412	462	802	918 ¹	1193 ¹
BB	1/4"-20	1/2"	265	356	425	464	1080	1288 ²	1735 ¹
BE	5/16"-18	3/4"	270	480	439	477	1400	1680	2118
BC	3/8"-16	3/4"	275	576	466	488	1745	1692	2523 ¹
BD	1/2"-13	3/4"	275	576	468	513	**2038 ²	2605	3150

* Failure measured as breakage of drywall portion

** Failure of block

¹ Stainless steel bolts used

² Hardened bolts used

³ Stainless steel channel tested with stainless bolts in 1/2" steel plate

Ultimate Shear (lb)

Anchor	UNC Thread	Drill Dia.	1/2" Drywall	5/8" Drywall
BA	3/16"-24	1/2"	247	298
BB	1/4"-20	1/2"	241	324
BC	3/8"-16	3/4"	292	406